

# SUZUKI GSX-R600 '11- '16

## M O U N T I N G I N S T R U C T I O N S

## VIDEO

REF 3163

SIDE SPOILER DOWNFORCE



1 Person



40 min



MEDIUM



N° 7

ALLEN

N° 2,5  
N° 3  
N° 4



ID	PIEZA/PART	DESCRIPCIÓN	DESCRIPTION	QTY	REF
1		Base alerón derecha	Right main plain spoiler	1	10622
2		Winglet Negro derecho Winglet Azul derecho	Right black winglet Right Blue winglet	1 1	10629
3		Base alerón izquierda	Left main plain spoiler	1	10622
4		Winglet Negro izquierdo Winglet Azul izquierdo	Left black winglet Left Blue winglet	1 1	10629
5		Soporte metálico derecho	Right metal suport	1	SOPOR2P3-R-3163
6		Soporte metálico izquierdo	Left metal suport	1	SOPOR2P3-L-3163
7		Tuerca autoblocante M4	M4 Locking nut	4	TUERCAE985-0290
8		Arandela de goma Ø4,5 x Ø11 x 2mm	Ø4,5 x Ø11 x 2mm Rubber washer	4	ARAND-EPDM--722
9		Arandela de nylon M4x0,5	M4x0,5 Nylon washer	8	ARNV00000000311
10		Tornillo Allen M4x12 Ø9 ISO 7380	M4x12 Ø9 ISO 7380 Allen screw	4	TORNI-I7380-800
11		Tuerca de clip M6	M6 clip nut	2	TUERCA-TRT-M6--
12		Tornillo Allen M6x20 Ø14 ISO 7380	Allen screw M6x20 Ø14 ISO 7380	2	TORNI-I7380-404
13		Casquillo Ø13 x Ø8,5 x 3,5	Ø13 x Ø8,5 x 3,5 Arrowhead	4	CASQUI-----775
14		Arandela de nylon M5x1	M5x1 Nylon washer	4	ARNV00000000245
15		Tornillo Allen M5x16 Ø11 ISO 7380	M5x16 Ø11 ISO 7380 Allen screw	2	TORNI-I7380-493
16		Tornillo Allen M5x11 Ø11 ISO 7380	M5x11 Ø11 ISO 7380 Allen screw	4	TORNI-AI----520
17		Tapón tornillo Allen M5 ISO 7380	M5 ISO 7380 Allen screw cap	4	TAPON-----85
18		Cinta adhesiva de doble cara 10x30mm (se suministra montada)	10x30mm double-sided adhesive tape (supplied assembled)	2	ADHESI-----263
19		Espuma adhesiva protectora 10x15mm (se suministra montada)	10x15mm Protective adhesive foam (supplied assembled)	2	ESPUMA-----264

# SUZUKI GSX-R600 '11- '16

INSTRUCCIONES DE MONTAJE - MOUNTING INSTRUCTIONS - MONTAGEANLEITUNG

**1**

DISASSEMBLY  
DESMONTAJE

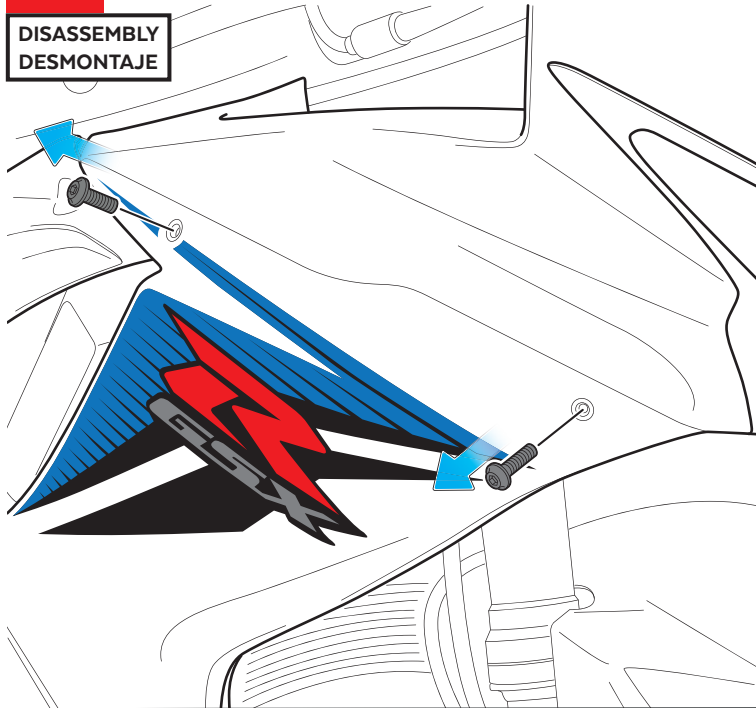

**2**

DISASSEMBLY  
DESMONTAJE

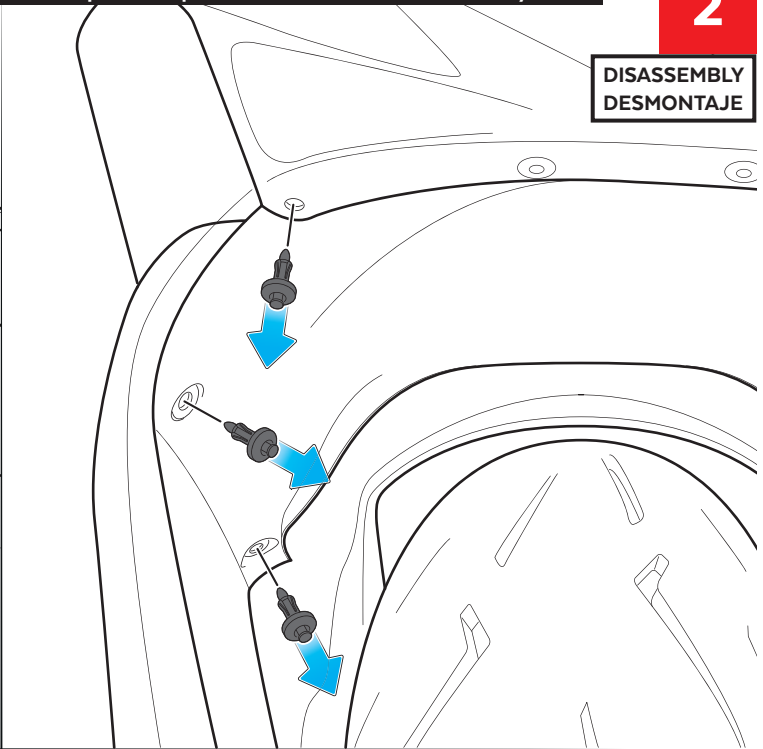

**3**

ASSEMBLY  
MONTAJE

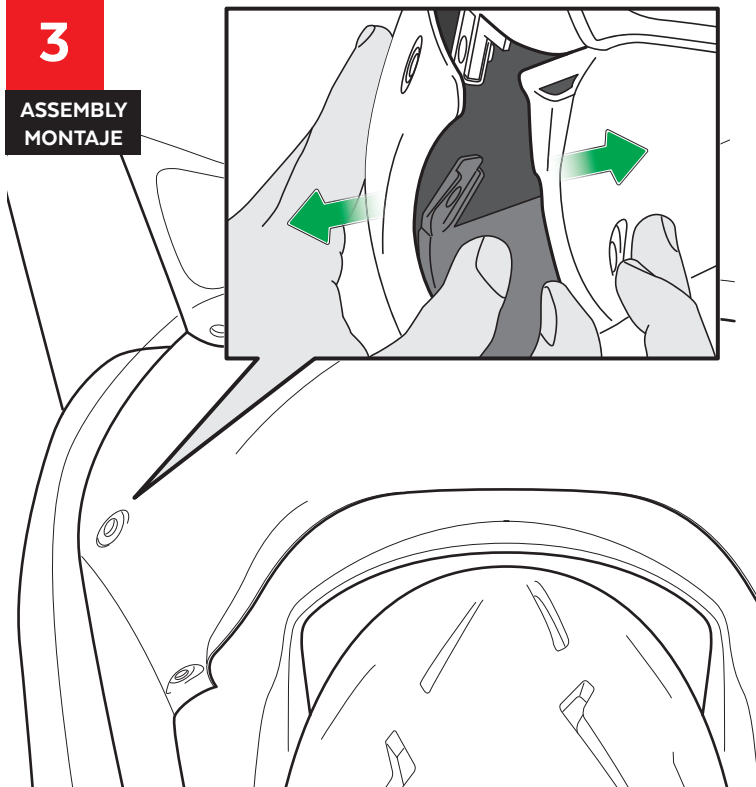

**4**

ASSEMBLY  
MONTAJE

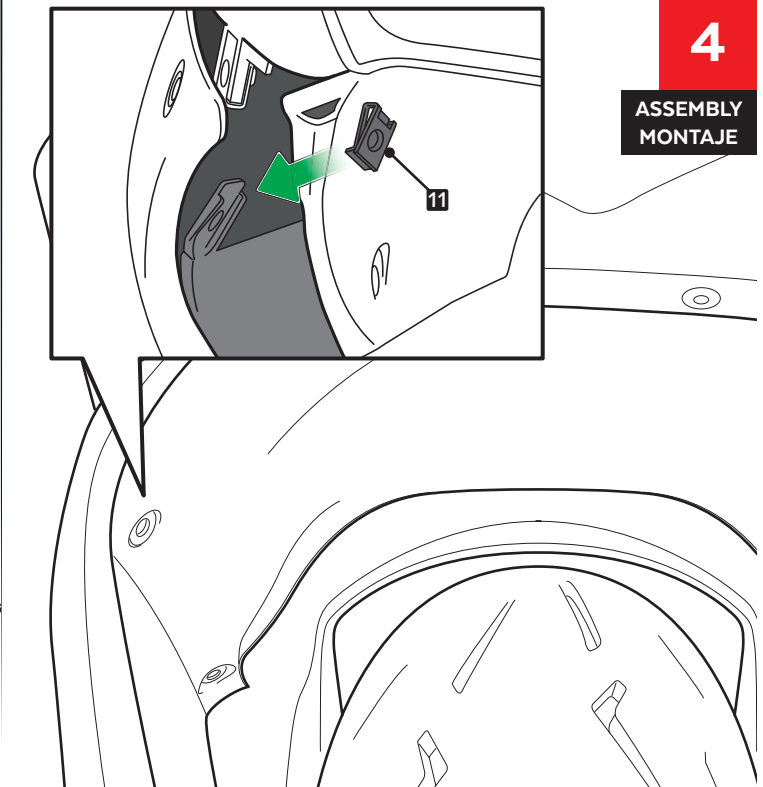

Se muestra el montaje del lado derecho a modo de ejemplo, realizar los mismos pasos para el montaje del lado izquierdo.  
The right side assembly is shown as an example, so the same steps can be performed for the left side assembly.

# SUZUKI GSX-R600 '11- '16

INSTRUCCIONES DE MONTAJE - MOUNTING INSTRUCTIONS - MONTAGEANLEITUNG

**5**

ASSEMBLY  
MONTAJE

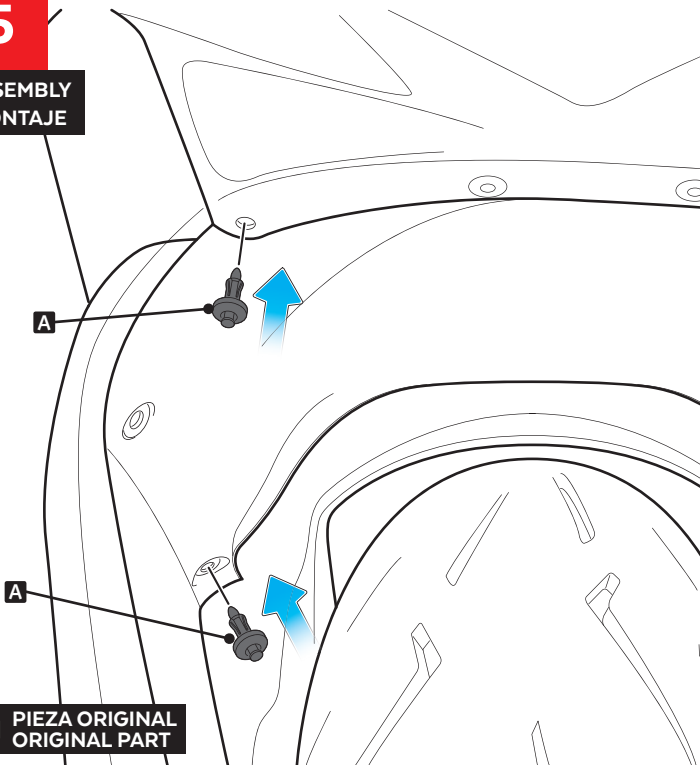

**6**

ASSEMBLY  
MONTAJE

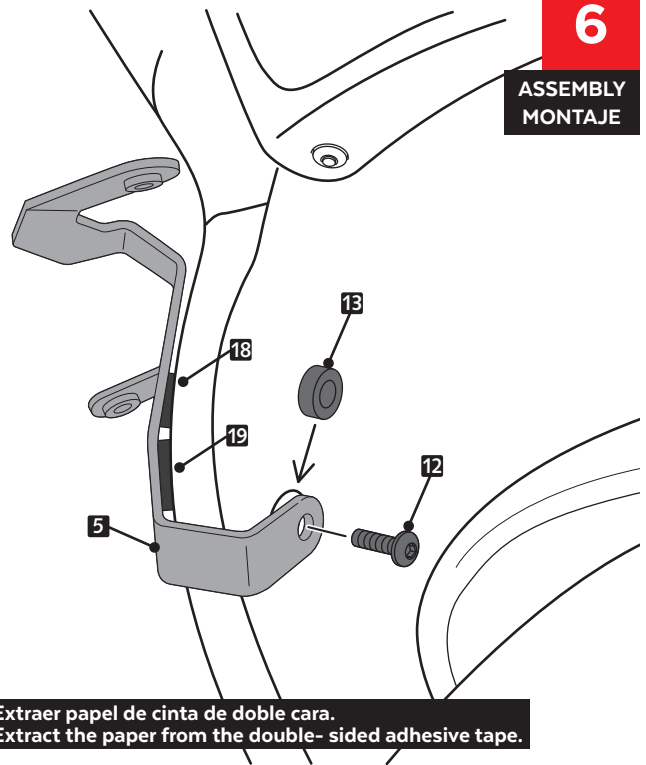

**7**

ASSEMBLY  
MONTAJE

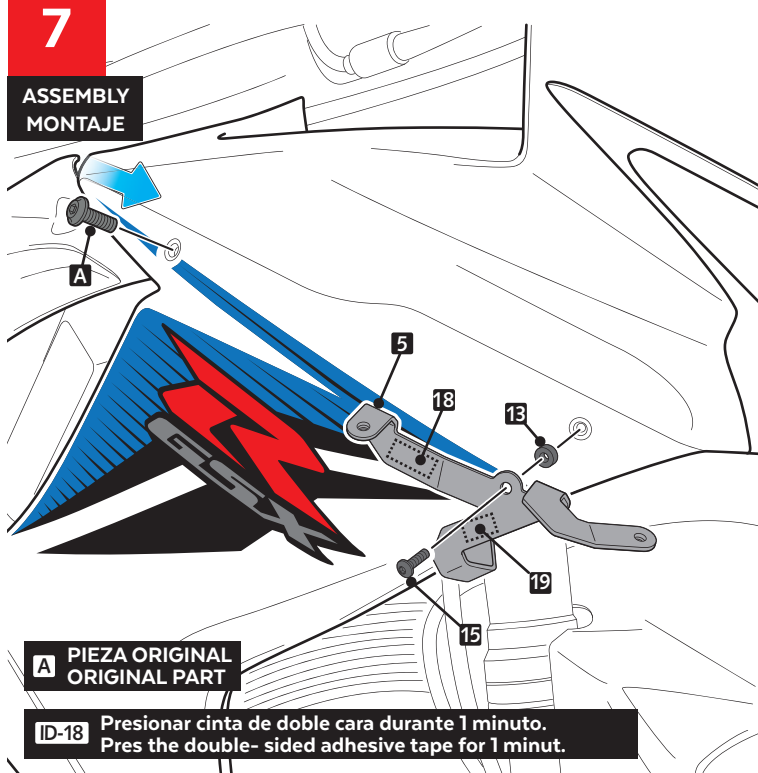

**8**

ASSEMBLY  
MONTAJE

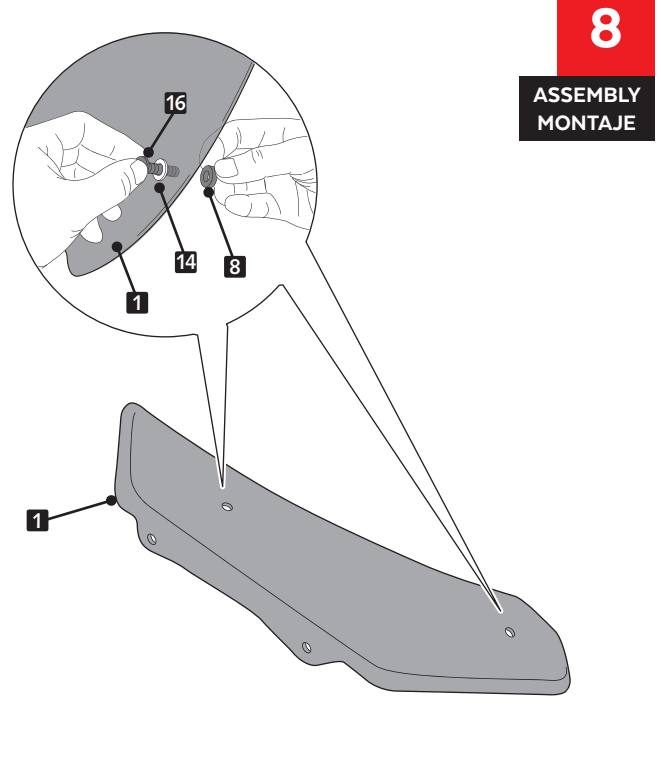

# SUZUKI GSX-R600 '11- '16

INSTRUCCIONES DE MONTAJE - MOUNTING INSTRUCTIONS - MONTAGEANLEITUNG

**9**

ASSEMBLY  
MONTAJE

