

#	DESCRIPTION	PART NUMBER	QTY
1	Silenziatore / Muffler db killer 50.DK.020.0	GP	1
2	Protezione in gomma per staffa / Rubber protection for bracket	50.73.077.1	1
3	Staffa / Bracket	50.SS.241.1	1
4	Vite M6 x 12 / Screw M6 x 12	50.72.024.1	2
5	Rondella M6 / Washer M6	50.72.027.1	4
6	Dado M6 / Nut M6	50.73.146.1	2
7	Dado M8 flangiato / Flanged nut M8	50.73.393.1	1
8	Rondella in alluminio nera / Black aluminium washer	50.73.221.1	1
9	Vite M8x40 / Screw M8x40	50.73.075.1	1
10	Fascetta Ø 52/55 mm / Pipe clamp Ø 52/55 mm	50.FA.008.1	1
11	Guarnizione in grafite / Graphite bush	50.72.45.50.30	1
12	Tubo di raccordo / Link pipe	9773KT024S2	1
13	Tubo in gomma per molla / Rubber pipe for spring	50.73.049.0	1
14	Molla lunga / Long spring	50.71.080.1	1

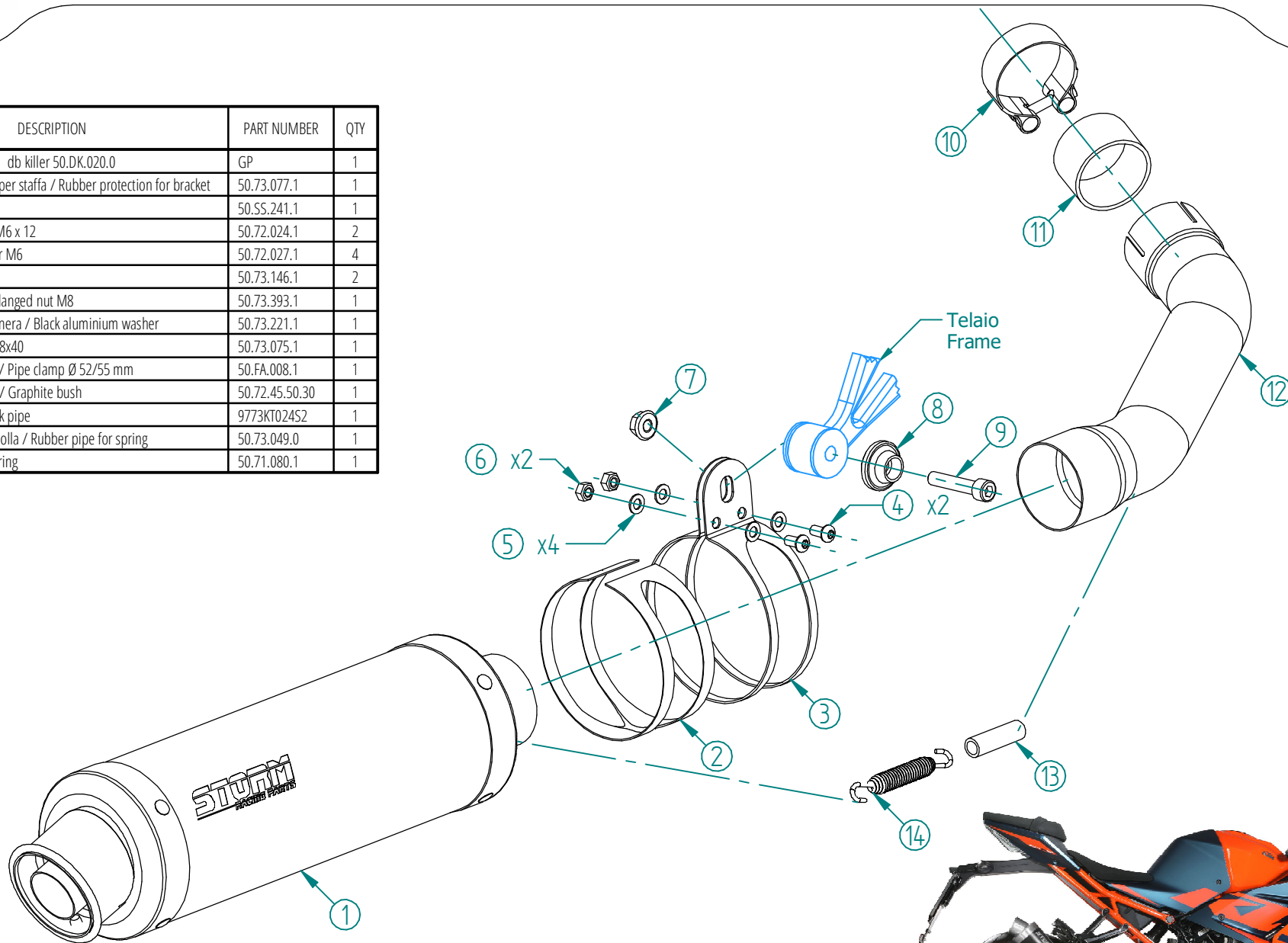

APPLICAZIONI / APPLICATIONS			
CODICE / CODE	SILENZIATORE / MUFFLER	FASCETTA / CLAMP	TUBO / PIPE
74.KT.030.LXS	INOX / ST. STEEL	INOX / ST. STEEL	INOX / ST. STEEL
74.KT.030.LXSB	STEEL BLACK		

